

Carolina

The UNIVERSITY of NORTH CAROLINA at CHAPEL HILL



CAROLINA NORTH DESIGN GUIDELINES

November 2008

Affiliated Engineers, Inc.
Biohabitats Incorporated
BNIM
Hoerr Schaudt Landscape Architects
Martin/Alexiou/Bryson, PLLC
Rummel, Klepper and Kahl, LLP
Stonebridge Associates, Inc.



Carolina North Design Guidelines

- Introduction
- Purpose
- Campus-Wide Design Guidelines
- Building Design Guidelines
- Process



Purpose

Carolina North will support the mission of the University.

- Facilitate new collaborations inside the University
- Create and strengthen strategic relationships outside the University
- Provide new space for research and education



Photo by Dan Sears



Purpose

Carolina North will respond to changing needs.

- Consider value of programmatic adjacencies in site selection.
- Provide opportunities for program growth over time.
- Maintain flexibility to respond to changing needs.



Campus Wide Design Guidelines – Landscape Districts

- Campus Frontage
- Entry Drive
- Central Green Way
- Working Landscape



The open space defines four distinct campus districts



Campus Frontage

- Establish campus identity with touchstone elements.
- Provide pedestrian improvements to Martin Luther King Jr. Blvd.
- Manage stormwater with streetscape and low maintenance landscape.
- Create campus crossroads at intersection with Central Green Way.

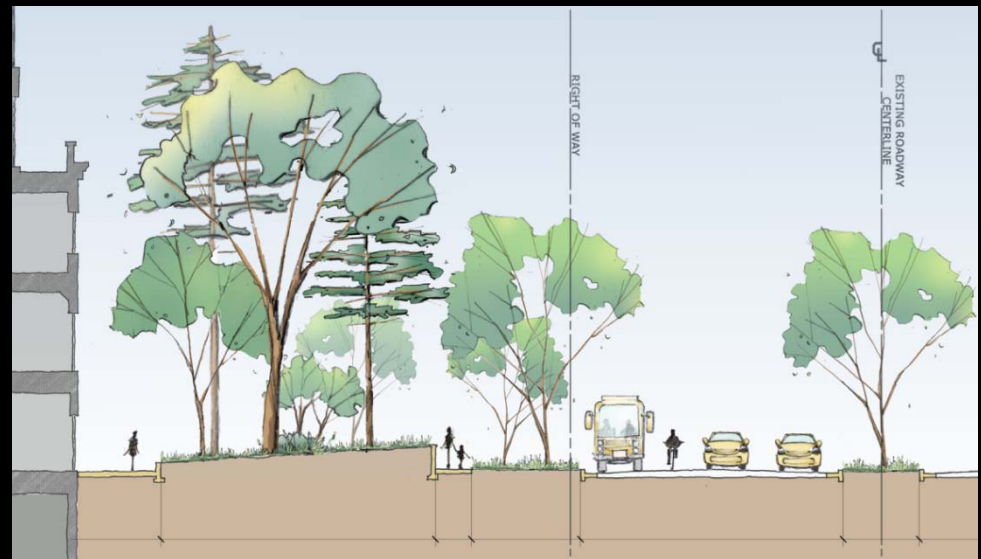

Campus Frontage

Buildings and programs support transit and town/campus interface.

- Height
- Massing and Geometry
- Setbacks
- Stepbacks

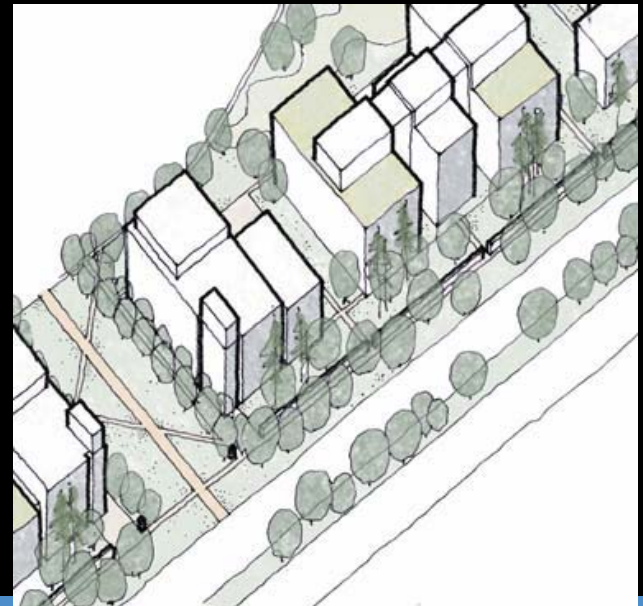

Entry Drive

- Bring community into the campus.
- Street section responds to solar orientation.
- South facing sidewalks will accommodate outdoor seating and gathering spaces.
- Create major campus plaza at intersection with Central Green Way.



Entry Drive

Dense development to support vibrant mixed use campus center.

- Height
- Setbacks
- Stepbacks
- Entries and street level design

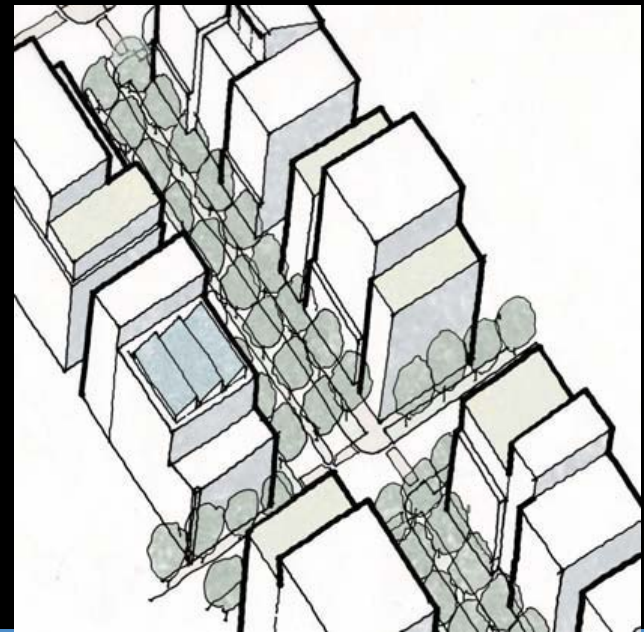

Central Green Way

- Connect town and campus to the forest
- Lawns
- Working landscape
- Small courtyards adjacent to buildings.

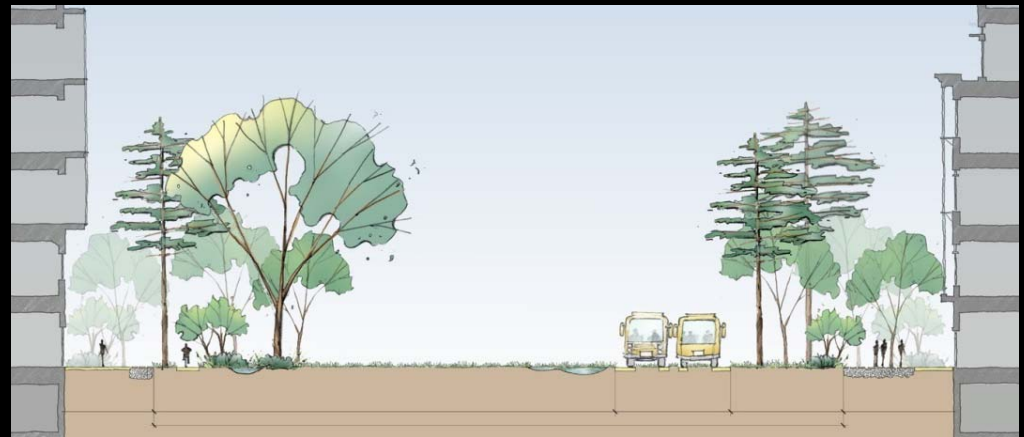

Central Green Way

Core campus buildings define Central Green Way and create mass of activity with direct access to transit.

- Height
- Setbacks
- Stepbacks
- Connectivity

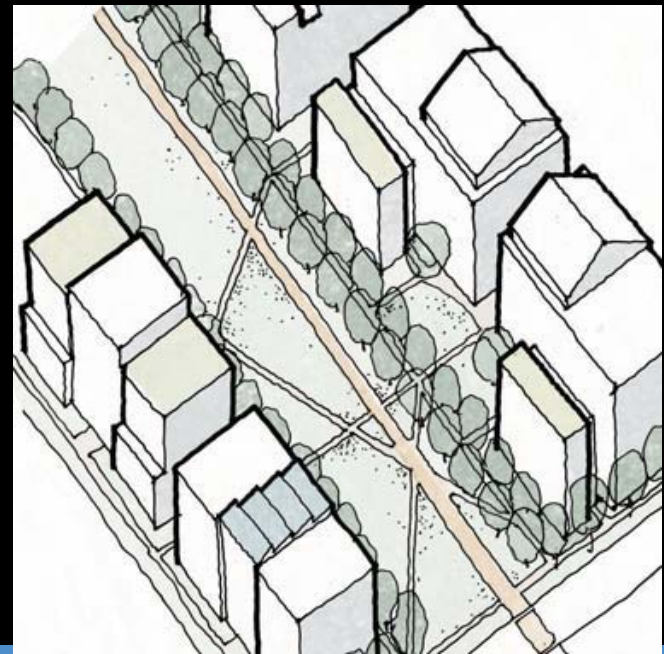

Working Landscapes

- Connect campus to existing natural areas.
- Provide aesthetic, social and recreational spaces.
- Manage stormwater and provide native habitat.
- Provide seasonal variety with native plants.



Campus Identity

Character of Carolina and Chapel Hill

Landmarks will develop as the campus evolves:

- Iconic indoor and outdoor spaces
- Gathering areas
- Signature buildings
- Public art

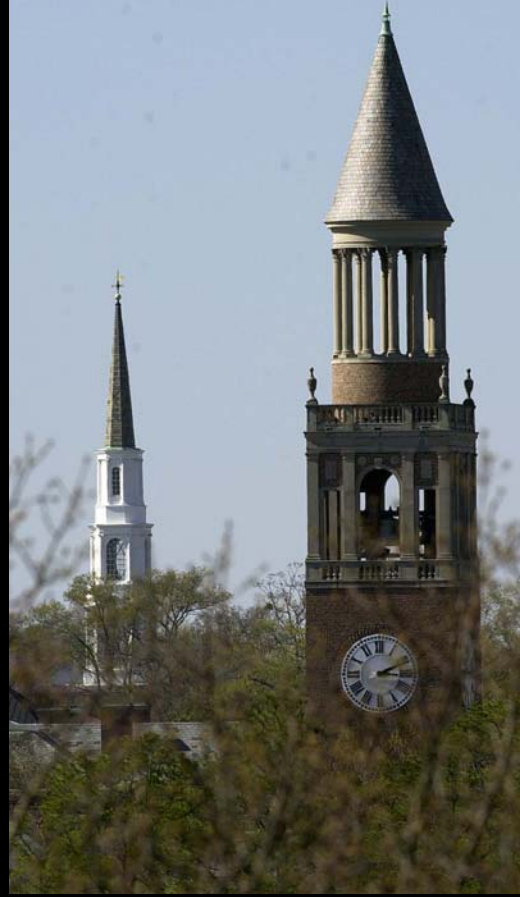

Building Design Guidelines

Design and Operations Performance

- Climate, Culture, and Place
- Carbon Footprint Reduction
- Conservation, Efficiency and Reliability
- Collaboration, Education and Outreach



Building Design Guidelines

- Orientation
- Height
- Massing
- Composition
- Materials
- Site Furnishings



Orientation

Orientation should be integrated into the overall design

- Incorporate shading and screening
- Create distinct elevations
- Provide Interior daylight
- create outdoor spaces
- Address open spaces
- Articulate entry and arrival
- Provide service entries



Height

Height ranges in scale from residential to institutional.

Varies in response to:

- Context
- Program
- Site capacity



Massing

- Footprints – efficient and responsive to solar orientation
- Height – varies in response to context, program, site capacity
- Setbacks - how the building meets the ground
- Stepbacks – how the wall is shaped vertically
- Geometry of roof form and cornice



Composition

Human Scale

- Active use at street level – active, visible uses with multiple entrances
- Clarity of entry – open, inviting, well-lighted
- Visual interest
- Shelter and safety – awning, colonnades, visibility
- Diverse gathering and social spaces



Materials

Proportion

- Overall
- Individual elements

Materials

- Local heritage
- Performance

Component Elements

- Legibility
- Balance innovation and practicality
- Detail



Duke University



Johns Hopkins University



Site Furnishings

Site Furnishings will be in keeping with existing Carolina style.

Alternatives may be selected for:

- Performance
- Availability



Animation View Key Plan



